



Infinity E - plan Aspheric Illumination Compound Optical Microscope A12.6603

Our Product Introduction

for more products please visit us on cnoec.com

Basic Information

- Place of Origin: China
- Brand Name: CNOEC, OPTO-EDU
- Certification: CE, Rohs
- Model Number: A12.6603
- Minimum Order Quantity: 1 pc
- Price: FOB \$1~1000, Depend on Order Quantity
- Packaging Details: Carton Packing, For Export Transportation
- Delivery Time: 5~20 Days
- Payment Terms: T/T, West Union, Paypal
- Supply Ability: 5000 pcs/ Month



Product Specification

- Type: Biological Microscope
- Optical System: Infinity Correct
- Light Source: 3W LED
- Magnification: 1000x
- Application: School
- Head: Binocular
- Highlight: optical compound microscope, wide field microscope



More Images



Product Description

Infinity E - plan Aspheric Illumination Compound Optical Microscope A12.6603

A12.6603 Laboratory Biological Microscope, Brand New Developed in 2014, is the best choice for your lab and school!

Perfect Optical System

Perfect Appearance Design

Perfect Ergonomics Design

●Infinity Correct Optical System Supply High Resolution And Perfect Definition

●Aspheric 3W LED Light Source

●Drop-Style Integrated Appearance Design, Looks Elegant

●High Rigidity Body Struction Design Supply High Steady

●Low Position Operation For Convenient Using

●New Cable Holder For Easy Keeping Cable

●Holding Hole On Back For Easy Carrying And Watching

Our Product Introduction



OPTO-EDU (BEIJING) CO., LTD.

F-1501 Wanda Plaza, No.18 Shijingshan Road, Beijing 100043, China
Tel:+8610 88696020 Fax:+8610 88696085

A12.6603

Biological Microscope

China Red Star Design Award



Unique Head And Frame Integrated Body To
Ensure The Stability Of Microscope Body



Unique Head And Frame Integrated Body & Integrated Design Of The Eyepiece Lens Barrel

Butterfly Type (Butterfly) Binocular Design, The Lens Barrel Can Be Rotated 360°, High Eyepoint Eyepiece, Which Is Convenient For People With Different Sitting Height; The Integrated Design Of The Eyepiece Lens Barrel, Avoids The Loss And Contamination Of The Eyepiece And Enhances The Integrated Performance Of The Microscope



Exclusive And Innovative Low-power Dimming Objective



Mechanical Stage Size 145×140mm
Travel Range 76×52mm

Exclusive And Innovative Low-power Dimming Objective & Mechanical Stage

No Need To Adjust The Brightness Between High And Low Power Objectives
Mechanical Stage Size 145×140mm, Travel Range 76×52mm



Abbe Condenser N.A.1.25, Iris Diaphragm, Spiral Up/Down
3W LED Illumination With Aspheric Collector

Condenser & Light Source

Abbe Condenser N.A.1.25, Iris Diaphragm, Spiral Up/Down, With Filter Holder
3W LED Illumination With Aspheric Collector



Coaxial Coarse & Fine Focusing



Observation Window At The Rear Of The Body



Wire Winding Device

Wire Winding Device & Observation Window At The Rear Of The Body

For Easy Handling And Storage; You Can See The Change Of Objective Magnification Even From The Back

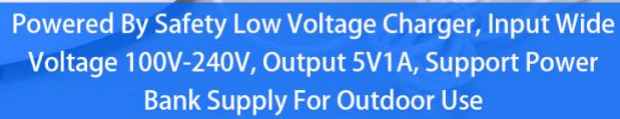

A31.6603-5.0MH

A31.6603-5.0M

A12.6603-B + Rackless (Integrated) Stage

A detailed image of a compound light microscope. The body is primarily white with black accents. It features a binocular eyepiece at the top left, a revolving nosepiece with multiple objective lenses, a black stage for specimen placement, and a large black base. A coarse focus knob is visible on the right side, and a smaller fine focus knob is located near the base. The microscope is shown from a three-quarter perspective against a plain white background.

[illegible]

Eyepiece	WF10x/18mm						●	●	●	●	●	A51.2602-1018
	WF10X/20mm (High Eyepoint)	●	●	●	●							A51.2602-1020
	WF16x/13mm		○	○	○	○	○	○	○	○	○	A51.2602-1613
	WF10x/18mm With Pointer		○	○	○	○	○	○	○	○	○	A51.2604-1018
	WF10x/18mm With Micrometer 0.1mm*180 Div		○	○	○	○	○	○	○	○	○	A51.2605-1018
	WF10x/18mm With Micrometer 0.1mm*180 Div, Diopter Adjustable		○	○	○	○	○	○	○	○	○	A51.2605-1018D
Nosepiece	Quadruple, Backward	●	●	●	●	●	●	●	●	●	●	A54.2610-N03
	EPLAN 4x/0.10, W.D.=12.1mm	●	●	○	○							A52.2605-4
Infinity Eplan Objective	EPLAN 10x/0.25, W.D.=4.14mm	●	●	○	○							A52.2605-10
	EPLAN 40x/0.65(S), W.D.=0.58mm	●	●	○	○							A52.2605-40
	EPLAN 100x/1.25(S, Oil), W.D.=0.19mm	●	●	○	○							A52.2605-100
Infinity Plan Objective	PLAN 2.5x/0.07, W.D.=8.47mm		○	○	○	○						A52.2606-2.5
	PLAN 4x/0.10, W.D.=12.1mm		○	○	●	●						A52.2606-4
	PLAN 10x/0.25, W.D.=4.64mm		○	○	●	●						A52.2606-10
	PLAN 20x/0.40(S), W.D.=2.41mm		○	○	○	○						A52.2606-20
	PLAN 40x/0.66(S), W.D.=0.65mm		○	○	●	●						A52.2606-40
	PLAN 60x/0.80(S), W.D.=0.33mm		○	○	○	○						A52.2606-60
	PLAN 100x/1.25(S, Oil), W.D.=0.12mm		○	○	●	●						A52.2606-100
	PLAN 100x/1.15(S, Water), W.D.=0.19mm		○	○	○	○						A52.2606-100W
Achromatic Objective	4x/0.1, W.D.=18.6mm						●	●	○			A52.2601-4
	10x/0.25, W.D.=6.5mm						●	●	○			A52.2601-10
	20x/0.40, W.D.=1.75mm							○	○	○		A52.2601-20
	40x/0.6(S), W.D.=0.47mm							●	●	○		A52.2601-40
	60x/0.80(S), W.D.=0.10mm								○	○		A52.2601-60
	100x/1.25(S, O), W.D.=0.07mm							●	●	○		A52.2601-100
Plan Objective	4x/0.1, W.D.=14.5mm							○	○	●		A52.2603-4
	10x/0.25, W.D.=5.65mm							○	○	●		A52.2603-10
	20x/0.40, W.D.=5.65mm								○	○		A52.2603-20
	40x/0.6(S), W.D.=0.85mm								○	○	●	A52.2603-40
	100x/1.25(S, O), W.D.=0.07mm								○	○	●	A52.2603-100
Working Stage	Mechanical Stage Size 145×140mm, Travel Range 76×52mm, Scale 0.1mm, Double Slide Holder	●	●	●	●	●	●	●	●	●	●	A54.2601-S04
	Rackless (Integrated) Stage, Size 140×135mm, Travel Range 75×35mm, Double Slide Holder	○	○	○	○	○	○	○	○	○	○	A54.2601-S12
Condenser	Abbe Condenser N.A.1.25, Iris Diaphragm, Spiral Up/Down, With Filter Holder	●	●	●	●	●	●	●	●	●	●	A56.2614-09
Focusing	Coaxial Coarse & Fine Focusing, Coarse Focusing Travel Range: 25mm, Fine Focusing Scale 2μm/Division	●	●	●	●	●	●	●	●	●	●	
Light Source	3W LED Illumination With Aspheric Collector Powered By Safety Low Voltage Charger, Input Wide Voltage 100V-240V, Output 5V1A, Support Power Bank Supply For Outdoor Use	●	●	●	●	●	●	●	●	●	●	A56.2612-3W
Adapter	1.0x C-Mount Focus Adjustable		○		○		○		○		○	A55.2601-10
	0.5x C-Mount Focus Adjustable		○		○		○		○		○	A55.2601-05
	0.75x C-Mount Focus Adjustable		○		○		○		○		○	A55.2601-75
	Digital Eyepiece Adapter, Dia.23.2mm/25mm		○		○		○		○		○	A55.2610
Dark Field	Dark Field Ring, For 4x~40x Objective	○	○	○	○	○	○	○	○	○	○	A5D.2611-B
Polarizing	Analyzer + Polarizer Set	○	○	○	○	○	○	○	○	○	○	A5P.2601-B3
Attachment	Wire Winding Device	●	●	●	●	●	●	●	●	●	●	A50.2602
Package	Carton Size 345×260×455mm, 1 Unit/Ctn											
Weight	Gross Weight 7.0kgs, Net Weight 5.5kgs											

Note:●In Table Is Standard outfits,○Is Optional Accessories.

Product Size(mm)

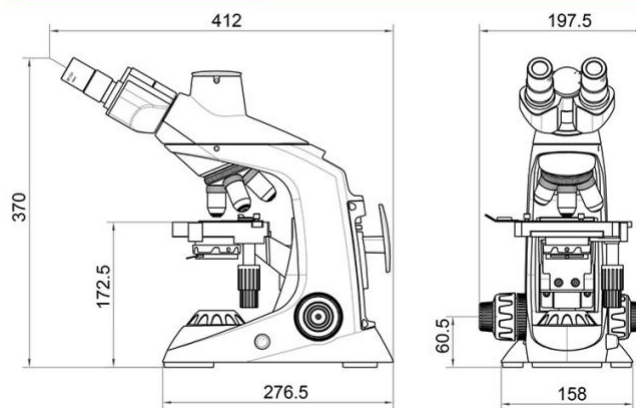

Product Accessories



A5D.2611-B
Dark Field Ring

A52.2606-100W
100x Water Objective

A5P.2601-B
Analyzer / Polarizer



Opto-Edu (Beijing) Co., Ltd.

0086 13911110627

sale@optoedu.com

cnoec.com

F-1501 Wanda Plaza, No. 18 Shijingshan Road, Beijing 100043, China