



OPTO-EDU A14.2605 Inverted Biological Phase Contrast Microscope, Transmit Light, ECO

Our Product Introduction

for more products please visit us on cnoec.com

Basic Information

- Place of Origin: China
- Brand Name: CNOEC, OPTO-EDU
- Certification: CE, Rohs
- Model Number: A14.2605
- Minimum Order Quantity: 1 pc
- Price: FOB \$1~1000, Depend on Order Quantity
- Packaging Details: Carton Packing, For Export Transportation
- Delivery Time: 5~20 Days
- Payment Terms: T/T, West Union, Paypal
- Supply Ability: 5000 pcs/ Month



Product Specification

- Certification: CE
- Drawtube: Trinocular
- Illumination: Halogen Lamp|LED
- Highlight: **digital trinocular microscope, infinity plan microscope**



More Images

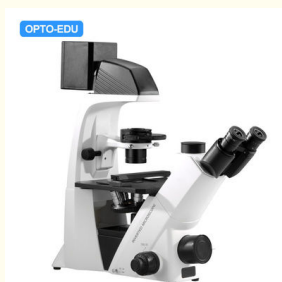

Product Description

Inverted Biological Phase Contrast Microscope, Transmit Light, ECO

Dual Photo & Video Channel Support Eyepiece / Digital Camera / SLR Camera View At Same Time

ECO Automatic Power Off Upon User Leaving 10 Minutes & Power On Upon User Back

LWD Infinity Plan Objectives Bright Field & Phase Contrast Observation Supported

4 Holes Disc Phase Contrast Condenser + Halogen 12V50W Koehler Illumination

Fluorescence Attachment Can Be Added Upgrade To A16.2614 Fluorescent Microscope

| Items | A14.2605 Inverted Biological Microscope Specification | Cata. No. |
|--|--|------------------|
| A14.2605 Upgraded From A14.2603 | --Dual Photo & Video Channel System --ECO Automatic Power Off System --4 Holes Disc Phase Contrast Condenser --Halogen 12V50W Koehler Illumination | |
| Head | Seidentopf Trinocular Head Inclined 45°, Interpupillary Distance 48~76mm, , Light Split Switch E100:P0 / E20:P80 Dual Photo & Video Channel Support Eyepiece View / Digital Camera/SLR Camera Take Picture & Record Video At Same Time: --Eyepiece View Has 100% Or 20% Light Switchable --Digital Camera Port Has 0% Or 80% Light Switchable --Photography Port 100% Light For SLR Camera (Standard Outfit Including SLR Camera Adapter 1pc) | ● A53.2643 |
| Eyepiece | WF10x/22mm, Dia.30mm, High Eyepoint,, Diopter Adjustable | ●● A51.2621-1022 |
| | WF15X/16mm, Dia.30mm, High Eyepoint, Diopter Adjustable | ○○ A51.2621-1516 |
| | WF20X/12mm, Dia.30mm, High Eyepoint, Diopter Adjustable | ○○ A51.2621-2012 |
| Nosepiece | Quintuple | ● A54.2610-N925 |
| LWD Infinity Plan Semi-APO Objectives Newly Update 2021 | L Plan FL 4x/0.11 W.D.=12.1mm | ● A5F.2635-4 |
| | L Plan FL 10x/0.25 W.D.=10.3mm | ○ A5F.2635-10 |
| | L Plan FL 20x/0.45 W.D.=5.8mm | ○ A5F.2635-20 |
| | L Plan FL 40x/0.65 W.D.=5.1mm | ○ A5F.2635-40 |
| LWD Infinity Plan Phase Contrast Semi-APO Objectives Newly Update 2021 | L Plan FL PHP 4x/0.10 W.D.=9.2mm | ○ A5C.2635-4 |
| | L Plan FL PHP 10x/0.25 W.D.=10.3mm | ● A5C.2635-10 |
| | L Plan FL PHP 20x/0.45 W.D.=5.8mm | ● A5C.2635-20 |
| | L Plan FL PHP 40x/0.65 W.D.=5.1mm | ● A5C.2635-40 |
| Phase Contrast | 4 Holes Rotating Disc Phase Contrast Condenser N.A.0.4, W.D. 45mm, Up/Down Adjustable | ● A56.2612 |
| | Centering Telescope 11x | ● A5C.2610 |
| Working Stage | Mechanical Stage Size 210x241mm, Round Slide Size Φ110mm | ● A54.2601-D4 |
| | Attachable Mechanical Stage For 96 Holes Plate Moving Range 128x80mm | ● A54.2605 |
| | Culture Dish Holder 65mm | ○ A54.2606-65 |
| | Culture Dish Holder 54mm | ● A54.2606-54 |
| | Culture Dish Holder 35mm | ○ A54.2606-35 |
| | Holder For Blood Cell Counter | ○ A54.2606-BC |
| | Universal Holder (New Accessory 2021) | ○ A54.2606-UH |
| Illumination | Koehler Illumination Halogen 12V/50W, Input Voltage 100V~240V | ● A56.2613-50W |
| | Koehler Illumination 5W LED, Input Voltage 100V~240V | ○ A56.2651-5W |
| Power | ECO, Auto Power Off System. Power Off Automatically Upon User Leaving 10 Minutes, Power On Automatically Upon User Approaching Detected, This Function Can Be Shut Down Manually | ● A56.2660 |
| Filter | Blue, Dia.34mm | ● A56.2616-34B |
| | Green, Dia.34mm | ● A56.2616-34G |
| | Amber, Dia.34mm | ○ A56.2616-34A |
| | Grey, Dia.34mm | ○ A56.2616-34N |
| Adapter | Photo Adapter With 1.7x Photo Eyepiece,100% Light For Camera Port, For Canon SLR Digital Camera | ● A55.2622-BC17 |
| | Photo Adapter With 1.7x Photo Eyepiece,100% Light For Camera Port, For Nikon SLR Digital Camera | ○ A55.2622-BN17 |
| | Photo Adapter With 2.5x Photo Eyepiece,100% Light For Camera Port, For Canon SLR Digital Camera With 1" CCD Sensor | ○ A55.2622-BC25 |

| | | | |
|--------------|---|---|---------------|
| | Photo Adapter With 2.5x Photo Eyepiece, 100% Light For Camera Port, For Nikon SLR Digital Camera With 1" CCD Sensor | ○ | A55.2622-BN25 |
| | C-Mount 0.5x, Focus Adjustable | ○ | A55.2601-05 |
| | C-Mount 0.75x, Focus Adjustable | ○ | A55.2601-75 |
| | C-Mount 1.0x, Focus Adjustable | ○ | A55.2601-10 |
| | Upgrade to A16.2615-L2 Inverted Fluorescence Microscope With: B,G China Fluorescent Filter 3 Holes Fluorescent Slide Unit, With Field Diaphragm, Center Adjustable 5W LED Lamp House 5W LED Power Box Ultraviolet Protection Barrier | ○ | A5F.2604-2 |
| Fluorescence | Upgrade to A16.2615-L4 Inverted Fluorescence Microscope With: B,G,U,UV China Fluorescent Filter 3 Holes Fluorescent Slide Unit, With Field Diaphragm, Center Adjustable 5W LED Lamp House 5W LED Power Box Ultraviolet Protection Barrier | ○ | A5F.2604-4 |



OPTO-EDU (BEIJING) CO., LTD.

F-1501 Wanda Plaza, No.18 Shijingshan Road, Beijing 100043, China
Tel: +8610 88696020 Fax: +8610 88696085

A14.2605

Inverted Biological Phase Contrast Microscope



Product Size(mm)

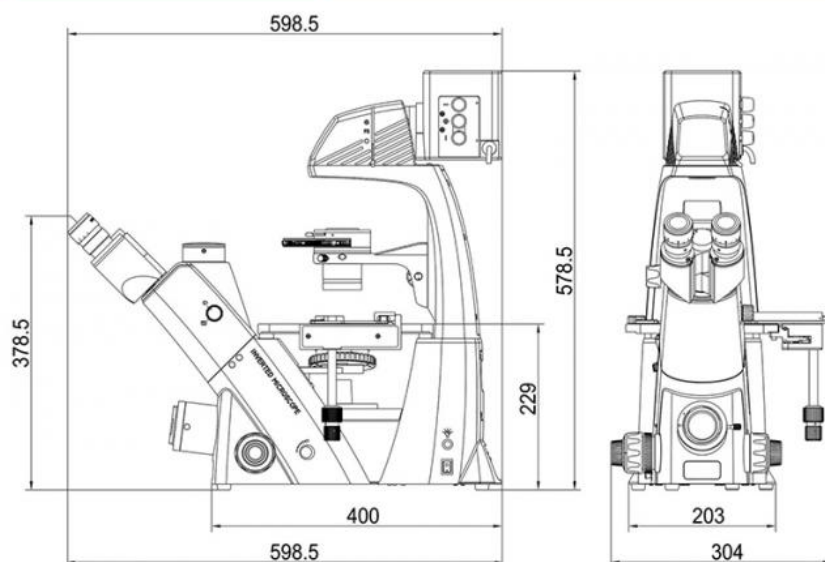

10x Objective
Observation Effect

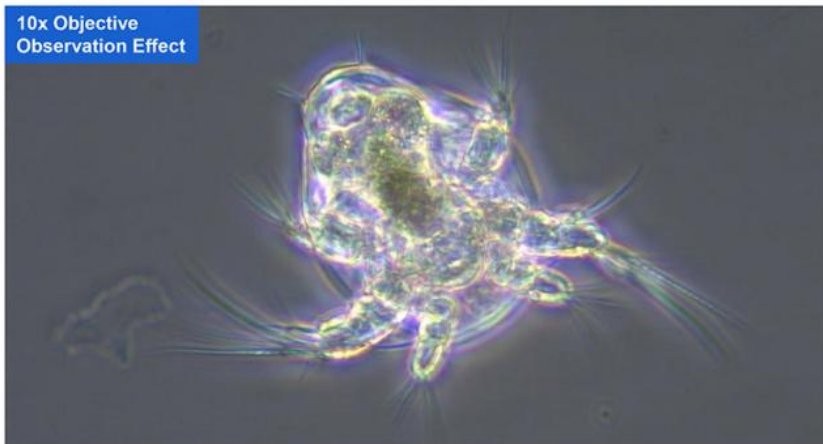

Product Accessories



A56.2612 4 Holes Rotating Disc Phase Contrast Condenser
A5C.2610 Centering Telescope 11x (Optional)
A5C.2611 Annular Spot 4x(Optional)



A51.2621-1022
WF10x/22mm



A51.2621-1516
WF15x/16mm



A51.2621-2012
WF20x/12mm

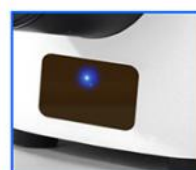

A56.2660
ECO, Auto
Power Off System



A52.2609 LWD Infinity Plan Objective: 10x, 20x, 40x
A5C.2630 LWD Infinity Plan Phase Contrast Objective: 20x



A55.2601-10
C-Mount 1.0x,
Focus Adjustable



A56.2616
Filter: Blue, Green;
Amber; Grey
(Optional)



A55.2601-75
C-Mount 0.75x,
Focus Adjustable



A54.2601-D4
Mechanical Stage
Size 210x241mm
Round Slide Size
Φ110mm



A55.2601-05
C-Mount 0.5x,
Focus Adjustable



A54.2606-65 & A54.2606-35
Culture Dish Holder 65mm & Culture
Dish Holder 35mm (Optional)



A54.2606-54
Culture Dish Holder 54mm

Upgraded To A16.2615-L LED Fluorescent Microscope



General Layout Diagram

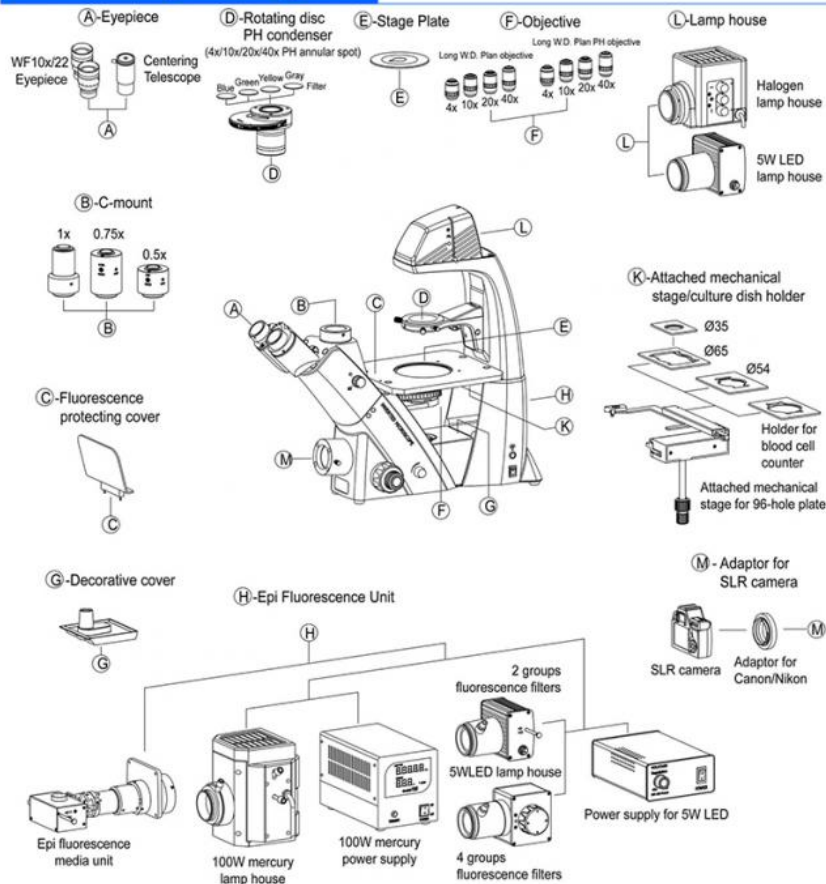

Opto-Edu (Beijing) Co., Ltd.

☎ 0086 13911110627

✉ sale@optoedu.com

🌐 cnoec.com

F-1501 Wanda Plaza, No. 18 Shijingshan Road, Beijing 100043, China