



OPTO-EDU A13.2607 Inverted Metallurgical Microscope, BF,PL

Our Product Introduction

for more products please visit us on cnoec.com

Basic Information

- Place of Origin: China
- Brand Name: CNOEC, OPTO-EDU
- Certification: CE, Rohs
- Model Number: A13.2607
- Minimum Order Quantity: 1 pc
- Price: FOB \$1~1000, Depend on Order Quantity
- Packaging Details: Carton Packing, For Export Transportation
- Delivery Time: 5~20 Days
- Payment Terms: T/T, West Union, Paypal
- Supply Ability: 5000 pcs/ Month



Product Specification

- Certification: CE
- Head: "Swiveling Siedentopf, Inclined 45°, IPD: 48-75mm, Light Distribution: 70:30 70% For Eyepiece, And 30% For Camera Tube "
- Eyepiece: WF10X/20mm, High Eyepoint
- Nosepiece: Quadruple
- Mechanical Stage: Three-layer Working Stage, Stage Size: 180×155mm, Moving Range: 75×40mm, Scale: 0.1mm, Round Slide Size ϕ 110mm
- Focusing: Coaxial Coarse And Fine, Coarse Stroke: 10mm, Fine Stroke Per Rotation: 0.2mm, Fine Division 2 μ m.
- Polarizing Unit: Polarizer, Analyzer
- Illumination: 5W LED Warm Lamp,
- Filter: Grey
- C-mount: 0.65×C-Mount, Built-in
- Holder: Universal Holder For HD Screen



More Images



Product Description

Invered Metallurgical Microscope, BF,PL

Professional Metallurgical Microscope For Bright Field, Polarizing Observation

Seidentopf Trinocular Head, Light Split E70:P30 No Need Switch

Metallurgical LWD Infinity Plan BF (Bright Field) Objectives

Large Working Stage Size 180x155mm, Moving Range 75x40mm, Scale 0.1mm

High Brightness Reflect Light 5W Warm LED Powered By 5V USB Port

Items	A13.2607 Inverted Metallurgical Microscope	
Head	Swiveling Siedentopf, Inclined 45°, IPD: 48-75mm, Light distribution: 70:30(70% For Eyepiece, And 30% For Camera Tube)	●
Eyepiece	WF10X/20mm, High Eyepoint	●
	WF10X/20mm, High Eyepoint, Adjustable Focus, Reticule 0.1mm	●
LWD Infinity Plan Objectives	LPL 5× 0.13, W.D.=16.04mm	●
	LPL 10× 0.25, W.D.= 18.48mm	●
	LPL 20× 0.40, W.D.= 8.35mm	●
	LPL 50× 0.70, W.D.= 1.95mm	●
	LPL 80× 0.80, W.D.= 0.85mm	○
	LMPlan FL 100× 0.85(Dry), W.D.= 3.00mm	○
Nosepiece	Quadruple	●
Mechanical Stage	Three-layer Working Stage, Stage size: 180×155mm, Moving Range:75×40mm, Scale: 0.1mm, Round Slide Size:φ110mm	●
Focusing	Coaxial Coarse And Fine, Coarse Stroke: 10mm, Fine Stroke PerRotation: 0.2mm, Fine Division 2 μm.	●
Polarizing Unit	Polarizer, Analyzer	●
Illumination	5W LED Warm Lamp, Powered By Safety Low Voltage Charger, Input Wide Voltage 100V-240V, Output 5V1A, Support Power Bank Supply For Outdoor Use	●
Filter	Grey	○
C-mount	0.65×C-Mount, Built-in	●
Holder	Universal Holder for HD Screen	○
HDMI Camera	With Measurement Function	○
HD Screen	10.1" HD LCD	○
Packing Size: 500mm×425mm×305mm Gross Weight:9.0 kgs Net Weight: 7.0 kgs		
Note: "●"In Table Is Standard outfits, "○" Is Optional Accessories.		



OPTO-EDU (BEIJING) CO., LTD.

F-1501 Wanda Plaza, No.18 Shijingshan Road, Beijing 100043, China
Tel:+8610 88696020 Fax:+8610 88696085

A13.2607

Inverted Metallurgical Microscope, BF,PL



**Polarizing
Analyzer & Polarizer & Grey Filter**

**5W LED Warm Lamp
Powered By Safety Low Voltage Charger**
Input Wide Voltage 100V-240V, Output
5V1A, Support Power Bank Supply For
Outdoor Use



Product Effect

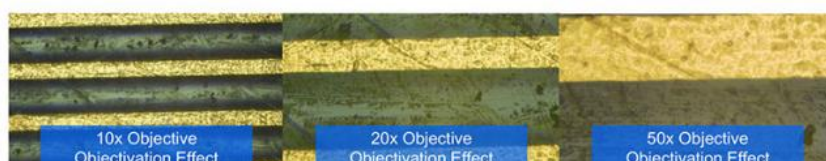

Perfect Images As Seen With A13.2607



Product Multi-angle

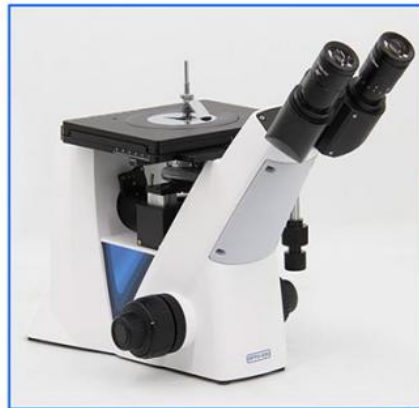

Product Overlook



CCD Adapter With Built-in 0.65x C-Mount On The Back To Connect Digital Camera



Screen Holder Optional To Hold Max 10.1" HD Screen Or Tablet

Product Specification

Items	A13.2607 Inverted Metallurgical Microscope	
Head	Swiveling Siedentopf, Inclined 45°, IPD: 48-75mm, Light distribution: 70:30 (70% For Eyepiece, And 30% For Camera Tube)	•
Eyepiece	WF10X/20mm, High Eyepoint	•
	WF10X/20mm, High Eyepoint, Adjustable Focus, Reticule 0.1mm	•
LWD Infinity Plan Objectives	LPL 5× / 0.13, W.D.=16.04mm	•
	LPL 10× / 0.25, W.D.= 18.48mm	•
	LPL 20× / 0.40, W.D.= 8.35mm	•
	LPL 50× / 0.70, W.D.= 1.95mm	•
	LPL 80× / 0.80, W.D.= 0.85mm	○
	LMPlan FL 100× / 0.85(Dry), W.D.= 3.00mm	○
Nosepiece	Quadruple	•
Mechanical Stage	Three-layer Working Stage, Stage size: 180×155mm, Moving Range:75×40mm, Scale: 0.1mm, Round Slide Size : φ110mm	•
Focusing	Coaxial Coarse And Fine, Coarse Stroke: 10mm, Fine Stroke Per Rotation: 0.2mm, Fine Division 2 μm.	•
Polarizing Unit	Polarizer, Analyzer	•
Illumination	5W LED Warm Lamp, Powered By Safety Low Voltage Charger, Input Wide Voltage 100V-240V, Output 5V1A, Support Power Bank Supply For Outdoor Use	•
Filter	Grey	○
C-mount	0.65×C-Mount, Built-in	•
Holder	Universal Holder for HD Screen	○
HDMI Camera	With Measurement Function	○
HD Screen	10.1" HD LCD	○
Packing Size: 500mm×425mm×305mm Gross Weight:9.0 kgs Net Weight: 7.0 kgs		
Note: "•"In Table Is Standard outfits, "○" Is Optional Accessories.		

www.optoedu.com

5

sale@cnoec.com

Structure And Nomenclature

A13.2607 Size(mm)

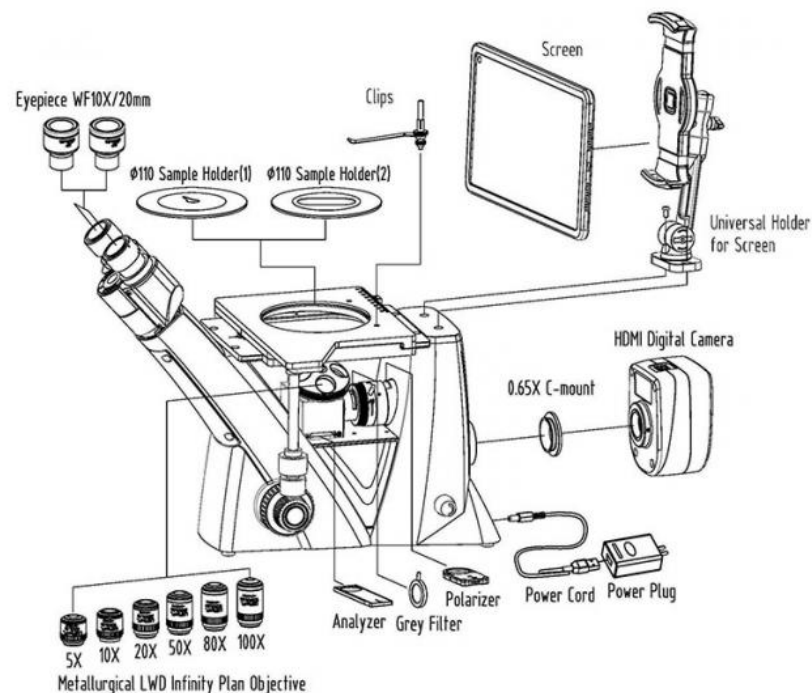
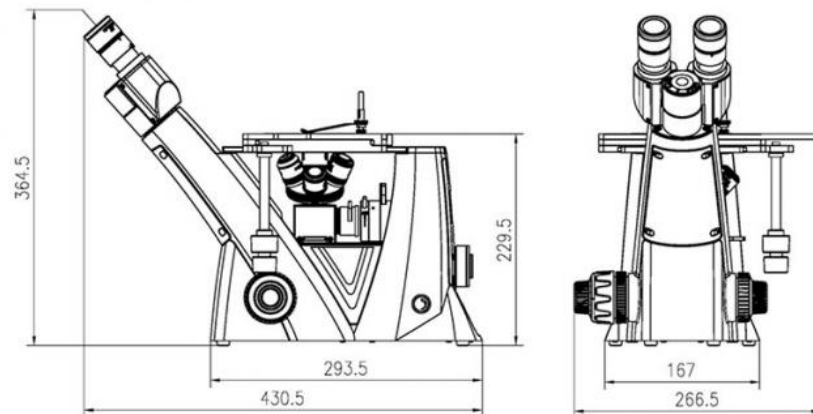



Opto-Edu (Beijing) Co., Ltd.



0086 13911110627



sale@optoedu.com



cnoec.com

F-1501 Wanda Plaza, No. 18 Shijingshan Road, Beijing 100043, China