



Trinocular Manual Transmit Reflect Optical Metallurgical Microscope

Our Product Introduction

for more products please visit us on cnoec.com

Basic Information

- Place of Origin: China
- Brand Name: CNOEC, OPTO-EDU
- Certification: CE, Rohs
- Model Number: A13.1091-TR
- Minimum Order Quantity: 1 pc
- Price: FOB \$1~1000, Depend on Order Quantity
- Packaging Details: Carton Packing, For Export Transportation
- Delivery Time: 5~20 Days
- Payment Terms: T/T, West Union, Paypal
- Supply Ability: 5000 pcs/ Month

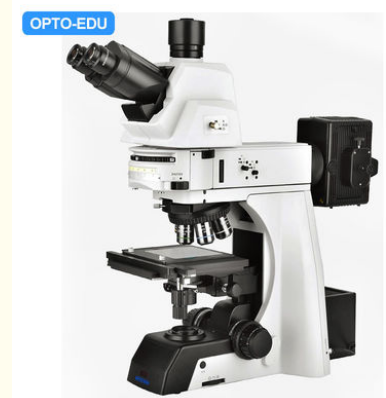

Product Specification

- Observation Method: Bright Field, Dark Field, Polarizing, DIC
- Main Body: BH Manual Body + Halogen Illumination
- Head: Ergo Tilting Trinocular Head, Inclination 0°~35°
- Eyepiece: SW10x/25mm, High Eyepoint, Diopter Adjustable, Dia.30mm
- Nosepiece: Manual Nosepiece, Sextuple, Backward
- Objective: N-MPFN Infinity Plan BF/DF Semi-APO Metallurgical Objective
- Highlight: trinocular optical metallurgical microscope,
manual transmit optical metallurgical microscope,
manual reflect optical metallurgical microscope



More Images

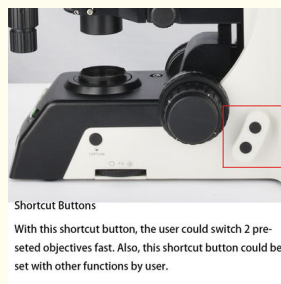

Product Description

Tilting Trinocular 0-35°, EW10x/25mm, Manual Sextuple Nosepiece, NIS45 Infinity Plan Semi-APO BD 5x10x, LWD 20x50x100x, 4" Stage 210x170/ 102x102mm, LWD Condenser N.A.0.65, Coaxial, Reflect 12V100W Halogen Illuminator, BD/BF1/BF2 Blocks, Filter B/G/Y/F, Reflect Polarizer & Analyzer, Reflect DIC Slide, Transmit 12V100W Halogen Kohler Illumination, ECO Function

A13.1091, A13.1093 Series Microscope

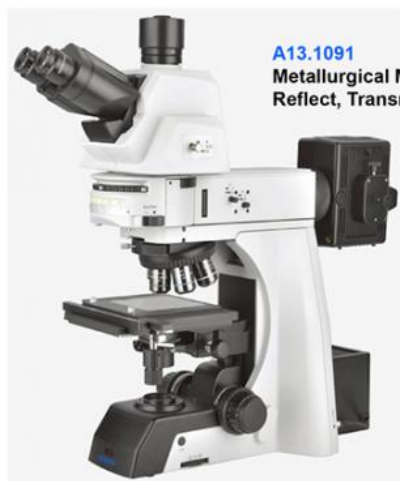

A13.1091
Metallurgical Microscope, Manual
Reflect, Transmit/Reflect



A13.1093
Metallurgical Microscope, Semi-Auto
Reflect, Transmit/Reflect

Product Details

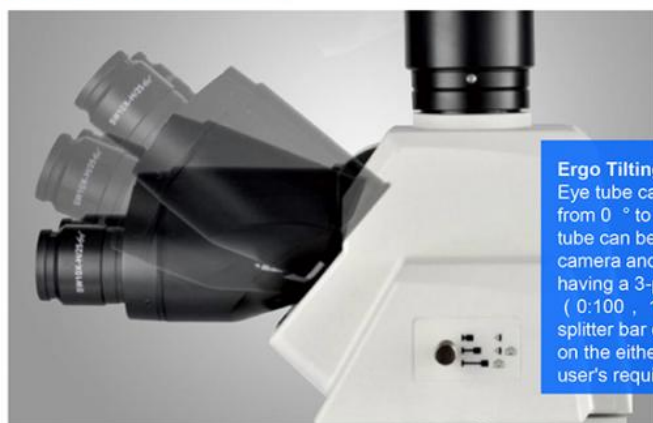

Ergo Tilting Trinocular Head
Eye tube can be adjustable from 0° to 35°, Trinocular tube can be connected to SLR camera and digital camera, having a 3-position beam splitter (0:100, 100:0, 80:20), the splitter bar can be assembled on the either side according to user's requirement.



Nomarski DIC
With newly designed DIC module, the height difference of a specimen which can not be detected with brightfield becomes a relief-like or 3D image. It is ideal for the observation of LCD conducting particles and the surface scratches of hard-disk etc.



A5M.1091, A5M1092 Series Infinity Plan BF/DF Semi-APO Objectives

By using carefully selected high- transparent glass and advanced coating technology, A5M.1091 objective lens can provide high resolution image and accurately reproduce the natural color of the specimen . For special applications, a variety of objectives is available, including polarizing and long working distance.

Focusing System

In order to make the system suitable for the operating habits of the operators, the knob of focusing and stage can be adjusted to the left-hand side or right-hand side. This design makes the operation comfortable



ECO Function

The microscope light would be off automatically after 30 minutes from operators leave. It can not only save energy, but also save the lamp lifetime.



A13.1091, A13.1093 Metallurgical Microscope, BF/DF, DIC, PL, APO		A13.1091		A13.1093		Cata.No.
		-R	-TR	-R	-TR	
Optical System	NIS45 Infinite Optical System	●	●	●	●	
	Bright Field	●	●	●	●	
Observation Method	Dark Field	●	●	●	●	
	Polarizing	●	●	●	●	
	DIC	●	●	●	●	
Main Body	BH Manual Body + Halogen Illumination.	●	●			A54.1090-BH
	BL Manual Body + LED Illumination.	○	○			A54.1090-BL
	ATH Semi-Auto Body + Halogen Illumination. Auto Nosepiece + Auto Condenser + Auto Brightness Adjust			●	●	A54.1090-ATH
	ATL Semi-Auto Body + LED Illumination. Auto Nosepiece + Auto Condenser + Auto Brightness Adjust			○	○	A54.1090-ATL
Head	Seidentopf Binocular Head, Inclined 30°, Interpupillary Distance 47-78mm	○	○	○	○	A53.1090-B
	Seidentopf Trinocular Head, Inclined 30°, Interpupillary Distance 47-78mm, 3 Level Ligth Split Switch E100:P0/E20:P80/E0:P100	○	○	○	○	A53.1090-T
	Ergo Tilting Trinocular Head, Inclination 0°~35°, Interpupillary Distance 47-78mm, 3 Level Ligth Split Switch E100:P0/E20:P80/E0:P100	●	●	●	●	A53.1090-TT

Eyepiece	SW10x/25mm, High Eyepoint, Diopter Adjustable, Dia.30mm	●●	●●	●●	●●	A51.1090-1025
	SW10x/22mm, High Eyepoint, Diopter Adjustable, Dia.30mm	○	○	○	○	A51.1090-1022
	EW12.5x/16mm, High Eyepoint	○	○	○	○	A51.1090-12516
	WF15x/16mm, High Eyepoint, Diopter Adjustable, Dia.30mm	○	○	○	○	A51.1090-1516
	WF20x/12mm, High Eyepoint, Diopter Adjustable, Dia.30mm	○	○	○	○	A51.1090-2012
Nosepiece	Manual Nosepiece, Sextuple, Backward	●	●			A54.1091-6M
	Coded Nosepiece, Sextuple, Backward, For Auto Brightness Adjust	○	○			A54.1091-6C
	Auto Coded Nosepiece, Sextuple, Backward, Motorized Switch Objectives, Controlled By: 1. Shortcut Button On Right Side Of Base, Can Switch 2 Preseted Objectives Quickly 2. Remote Control Pad In Front Of Base, Press Each Button To Switch Objectives And Adjust The Light Intensity Automatically. 2 Buttons Can Be Self-Defined For Most Commonly Used Objectives, Press Green Button Can Swap Between Them			●	●	A54.1091-6A
	With Slot For Polarizing Compensator Slider Or DIC Slider	●	●	●	●	
	Protect Cover For Nosepiece Holes	●	●	●	●	A54.1091-C
NIS45 N-MPFN Infinity Plan BF/DF Semi-APO Metallurgical Objective	BD 5x/0.15, W.D.20mm, No Cover Glass	●	●	●	●	A5M.1091-5
	BD 10x/0.3, W.D.11mm, No Cover Glass	●	●	●	●	A5M.1091-10
	BD 20x/0.45, W.D.3mm, No Cover Glass	○	○	○	○	A5M.1091-20A
	BD LWD 20x/0.4, W.D.12mm, No Cover Glass	●	●	●	●	A5M.1091-20
	BD LWD 50x/0.5, W.D.10.6mm, No Cover Glass	●	●	●	●	A5M.1091-50
	LWD 100x/0.8, W.D.3.5mm, No Cover Glass	●	●	●	●	A5M.1091-100
NIS45 BF/DF APO	BD 50x/0.8, W.D.1mm, No Cover Glass	○	○	○	○	A5M.1092-50
	BD 100x/0.9, W.D.1mm, No Cover Glass	○	○	○	○	A5M.1092-100
Working Stage For Metallurgical Microscope	4" Working Stage, Size 210x170mm, Move Range 4"x4" (102x102mm), Right Handle Optional, Hard Oxide Surface, Y Can Be Locked	●	●	●	●	A54.1093-L
	4" Working Stage, Size 210x170mm, Move Range 4"x4" (102x102mm), Left Handle Optional, Hard Oxide Surface, Y Can Be Locked	○	○	○	○	A54.1093-R
	Round Crystal Holder, For 2",3",4" Diameter Crystal	●	●	●	●	A54.1093-H1
	Wafer Holder	●	●	●	●	A54.1093-H2
	Glass Substrate, Size 145(X)x152(Y)mm	●	●	●	●	A54.1093-H3
	Metal Stage Plate, Size 145(X)x152(Y)mm	●	●	●	●	A54.1093-H4
Condenser	LWD Condenser, N.A.0.65, W.D.10.2mm, Center Adjustable, Dual Condenser Lifting Handle	●	●	●	●	A5M.1095
Focusing	Coaxial Coarse & Fine Focusing, Fine Division 0.001mm, Focusing Range 35mm, Coarse Stroke 37.7mm, Fine Stroke 0.1mm, Can Exchange Hand Wheel Between Left/Right,	●	●	●	●	
	Max Sample Space 76mm	●		●		
	Max Sample Space 56mm		●		●	
	Reflect Epi Metallurgical Illuminator, Turret Disc With 6 Positions For Filter Block, Kohler Illumination	●	●	●	●	A5M.1090

Reflect Light Source	12V100W Halogen Lamp Housing	●	●	●	●	A5M.1090-100W
	BF/DF View Block	●	●	●	●	A5M.1090-BD
	BF1 View Block	●	●	●	●	A5M.1090-B1
	BF2 View Block	●	●	●	●	A5M.1090-B2
Filter For Reflect Light Source	Filter Blue	●	●	●	●	A56.1093-B
	Fibler Green	●	●	●	●	A56.1093-G
	Filter Yellow	●	●	●	●	A56.1093-Y
	Filter Forested	●	●	●	●	A56.1093-F
Polarizing	Polarizer For Reflect Light Source	●	●	●	●	A5P.1090-RP
	Analyzer For Reflect Light Source	●	●	●	●	A5P.1090-RA
DIC	Blank Slider	●	●	●	●	A5P.1090-E
	Nomarski DIC Slider For Reflect Light Source	●	●	●	●	A5M.1090-DIC
Transmit Light Source	Transmit Kohler Illumination, Brightness Adjustable, 12V100W Halogen, External Lamp House		●		●	A56.1090-12V100W
	Transmit Kohler Illumination, Brightness Adjustable, 3W S-LED, Built-in Main Body		○		○	A56.1090-3WLED
	ECO Function Support Auto Power Off After 30 Mins From Operator Leave To Save Energy		●		●	A56.1090-ECO
	Auto Brightness Adjust, Brightness For Each Objective Can Be Memorized And Restored When Objective Is Selected		○		●	A56.1090-AB
	A13.1091 Upgradeable To Auto Brightness Adjust, Must Upgrade To A54.1091-6C Coded Nosepiece At Same Time					
Filter For Transmit Light Source	Filter Holder On Base, Can Hold 3 Filters		●		●	A56.1092-H
	Filter LBD		●		●	A56.1092-LBD
	Filter Green		●		●	A56.1092-G
	Filter Yellow		●		●	A56.1092-Y
	Filter ND6		●		●	A56.1092-ND6
	Filter ND25		●		●	A56.1092-ND25
Adapter	Eyepiece Adapter Dia.23.2mm	○	○	○	○	A55.1090-E
	C-Mount 1.0x	○	○	○	○	A55.1090-1.0x
	C-Mount 0.5x	○	○	○	○	A55.1090-0.5x
Software	NOMIS Basic Image Processing Software	○	○	○	○	A30.1090
Other Accessories	Working Stage Holder Bracket	●	●	●	●	A54.1096
	Adapter To Adjust Eye Position	○	○	○	○	A54.1096-A1
	Adapter To Lower The Stage Position 1"	○	○	○	○	A54.1096-A2
	Immersion Oil	○	○	○	○	A50.1090-01
	Allen Wrench	●	●	●	●	A50.1090-02
	Power Cord	●	●	●	●	A50.1090-03
	Short Eye Cover, For Eyepiece	○	○	○	○	A50.1090-04

Long Eye Cover, For Eyepiece	○	○	○	○	A50.1090-05
Eyepiece Micrometer, Cross	○	○	○	○	A50.1090-06
Adapter Ring To Install Eyepiece Micrometer	○	○	○	○	A50.1090-07
USB Cable	○	○	○	○	A50.1090-08
Note: "●" In Table Is Standard Outfits, "○" Is Optional Accessories "-" Is Unavailable					



Opto-Edu (Beijing) Co., Ltd.



0086 13911110627



sale@optoedu.com



cnoec.com

F-1501 Wanda Plaza, No. 18 Shijingshan Road, Beijing 100043, China