



Trinocular Halogen Lamp Metallurgical Microscope

Our Product Introduction

Basic Information

- Place of Origin: China
- Brand Name: CNOEC, OPTO-EDU
- Certification: CE, Rohs
- Model Number: A13.0912-A
- Minimum Order Quantity: 1 pc
- Price: Depend on Order Quantity
- Packaging Details: Carton Packing, For Export Transportation
- Delivery Time: 5~20 Days
- Payment Terms: T/T, West Union, Paypal
- Supply Ability: 5000 pcs/ Month



Product Specification

- Application: Research
- Certification: CE|Rohs
- Drawtube: Trinocular
- Illumination: Halogen Lamp
- Magnification: 50X-500X
- Theory: Metallurgical Optical Microscope
- Highlight: **reflected light microscope,**
halogen lamp microscope



More Images



Product Description

Infinity Color Corrected Optical System Metallurgical Optical Microscope A13.0912

Introduction

A13.0912 Inverted Metallurgical Microscope is widely applied for the research of cast, smelt, heat treatment and the inspection of raw material and material processing, as well as food safety evaluation, medical test and geological test.





Head & Eyepiece

45° Inclined, IPD 50-75mm
Plan WF10x/22mm, Diopter Adjustable



Working Stage

Right Hand Controls, Low Positioned, Three-Layer
Mechanical Stage, Size 240x250mm, Moving Range
50x50mm, Both Way Linear Guide Rail



DIC Slot & Slide

BD Quintuple Nosepiece With DIC Slot



Coded Nosepiece

Make the objective lens and screen magnification display correspond to the



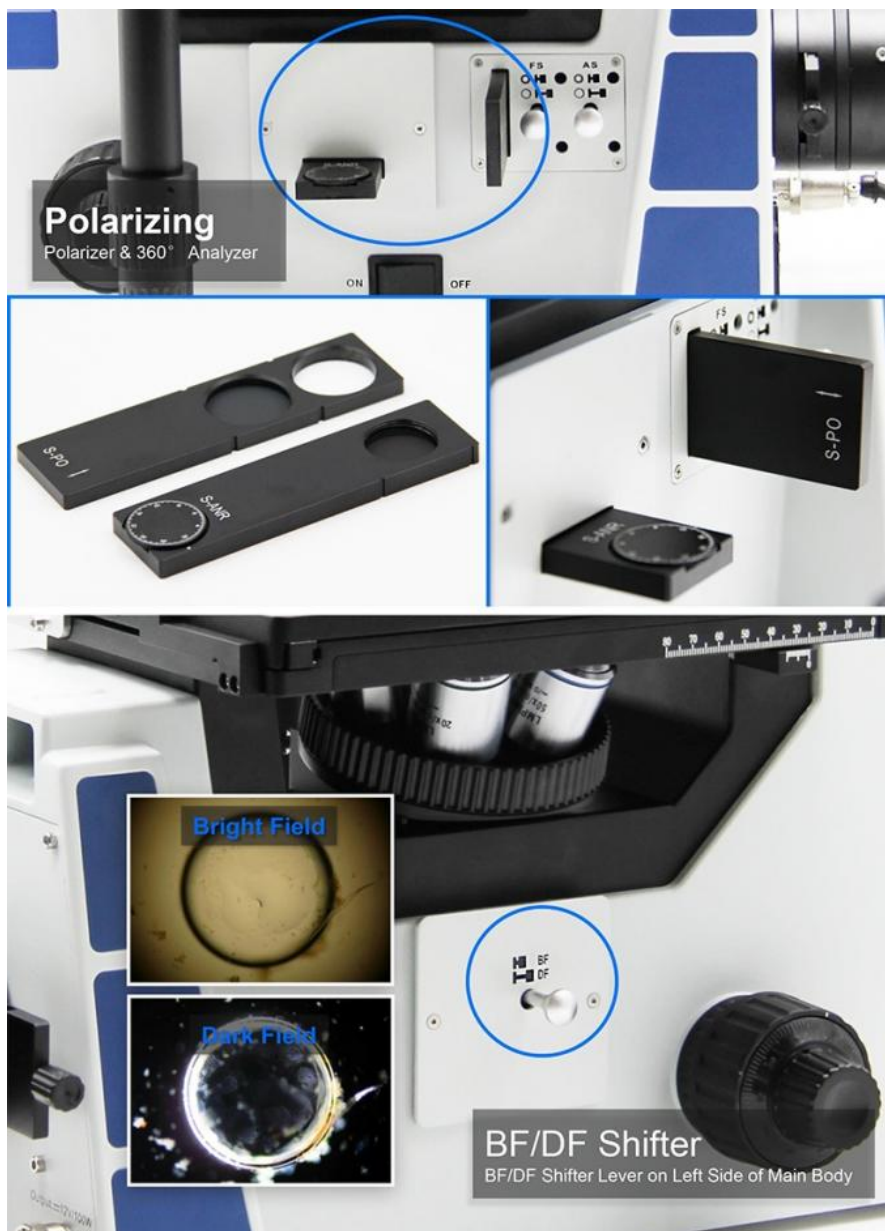

Specification

A13.0912 Inverted Metallurgical Microscope	
Optical System	Infinity Color Corrected Optical System
Frame	One-piece Construction, With Filter Slot & Polarizing Slot
Head	Trinocular Head, Split Ratio 100:0 or 0:100, 45° Inclined, 360° Rotatable, IPD 50-75mm,
Eyepiece	Plan WF10x/22mm, Diopter Adjustable, Reticle Attachable, High Eye-point,
Field	Bright & Dark Filed, With BD Shifter
Objective	Infinity LWD BD Plan Achromatic Metallurgical Objective DIC-5x/0.15 WD11mm
	Infinity LWD BD Plan Achromatic Metallurgical Objective DIC-10x/0.3 WD9.5mm
	Infinity LWD BD Plan Achromatic Metallurgical Objective DIC-20x/0.45 WD3.4mm
	Infinity LWD BD Plan Achromatic Metallurgical Objective 50x/0.55 WD7.5mm
Focus System	Coaxial Coarse & Fine Focusing System With Adjustable Tension, Coarse Range 9mm (6.5mm up & 2.5mm down), Fine Precision 2μm,
Nosepiece	BD Quintuple Nosepiece With DIC Slot
Condenser	LWD N.A. 0.30 With Iris Diaphragm And Aperture Disphragm, Both Centers Adjustable
Stage	Right Hand Controls, Low Positioned, Three-Layer Mechanical stage, size 240x250mm, moving range 50x50mm, Bothway Linear Guide Rail, Metal Specimen Holder (Dia. 25)
Light Source	Reflected Halogen Lamp, 12V100W
	Light Indicator
	Brightness Adjustable
	ECO Infrared Induction System (Auto on/off)
	External Wide Voltage Transformer, 100V-240V Input, 12V13.4A Output,

Polarization	Polarizer & 360° Analyzer	
Other	Power cord	
Optional Accessories		Item No.
Eyepiece	Plan WF15x/16mm, Diopter Adjustable, Reticle Attachable, High Eye-point	
Objective	Infinity LWD BD Plan Achromatic Metallurgical Objective 100x/0.8 WD2.1mm	
Adapter	035x C-Mount	
	0.5x C-Mount	
	0.65x C-Mount	
	1x C-Mount	
DIC	DIC Slider	



Dust Proof Slide For Polarizing Slot And
Dust Proof Slide For DIC Slot



Polarization: Polarizer & 360° Analyzer



Reflected Halogen Lamp, 12V100W



Brightness Indicator & Objectives Indicator
ECO Infrared Induction System (Auto On/Off)



Coaxial Coarse & Fine Focusing System With Adjustable Tension, Coarse Range
9mm (6.5mm up & 2.5mm down), Fine Precision 2 μ m



Opto-Edu (Beijing) Co., Ltd.



0086 13911110627



sale@optoedu.com



cnoec.com

F-1501 Wanda Plaza, No. 18 Shijingshan Road, Beijing 100043, China